

Find the Toolbar

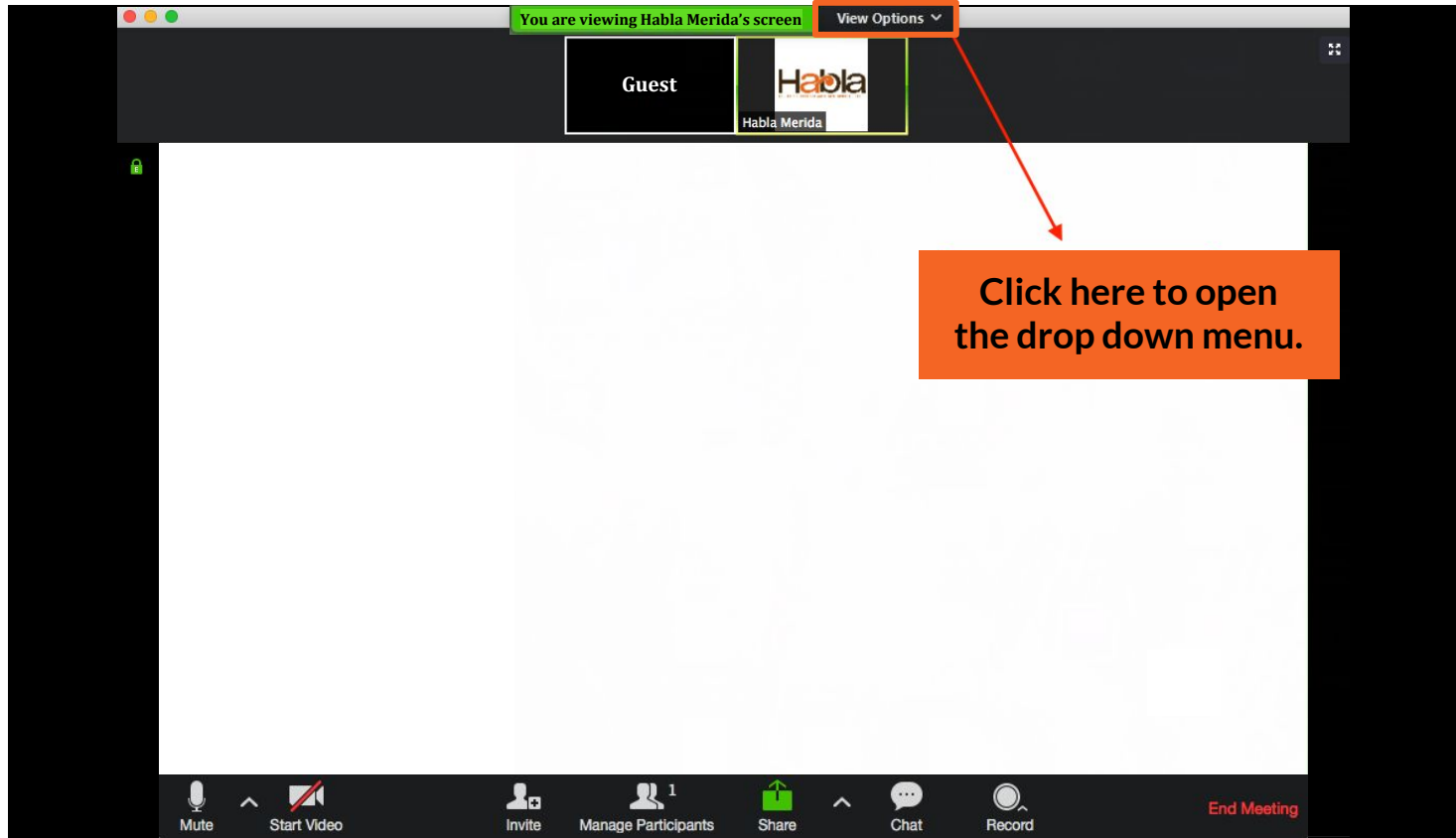

Find the Toolbar

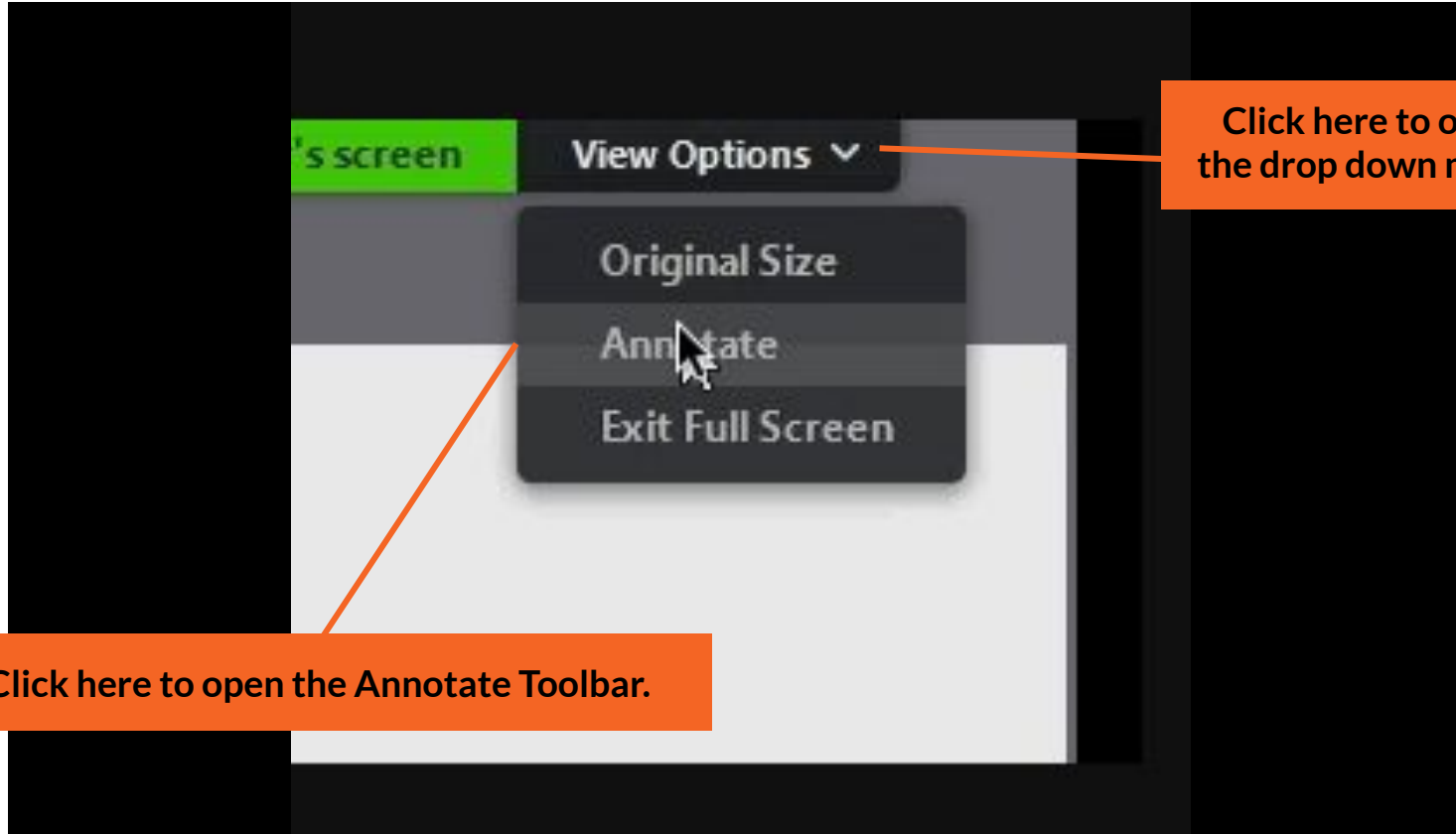

Click here to open the drop down menu.

Click here to open the Annotate Toolbar.

Uses of the Toolbar

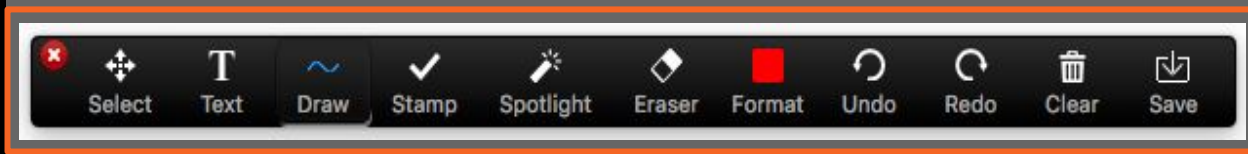

You can:

- Select
- Write
- Draw
- Add stamps
- Erase
- Format
- Undo
- Redo
- Clear

All these actions will appear on the whiteboard (the white background).

This is the Toolbar.